

ProSeal™ Injector (Syringe Adaptor)

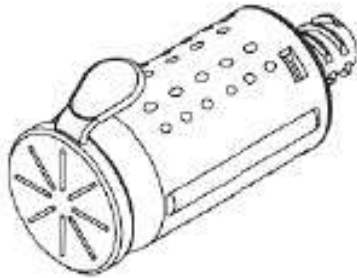

REF 421015

Priming Volume 0.02 ml

Gauge of Cannula 18G

External Fitting Female Luer Lock (ISO 80369-7)

Compatible with DMA (Dimethylacetamide)

NOT MADE with NATURAL RUBBER LATEX or DEHP



www.epic-med.com

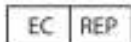

MT Promedt Consulting GmbH
Altenhofstr. 80
66386 St. Ingbert Germany
+49-6894-581020



Epic International (Thailand) Co., Ltd.
Hemaraj Eastern Seaboard Industrial Estate
500/73 Moo 2, Tasit, Pluakdaeng, Rayong
Thailand 21140

780155 Rev.01, Date of issue 2022-01-21

Indications for Use:

The ProSeal Closed System drug Transfer Device (CSTD) mechanically prohibits environmental contaminants from entering the system and the escape of drug or vapor concentrations from the system, thereby minimizing individual and environmental exposure to drug vapor, aerosols, and spills. The ProSeal system also prevents the introduction of microbial contaminants into the drug or fluid path for up to 168 hours or 7 days.

CE 0123

STERILE EO



DEHP FREE



Rx

Caution: Federal (U.S.A.) law restricts this device to sale by or on the order of a physician.

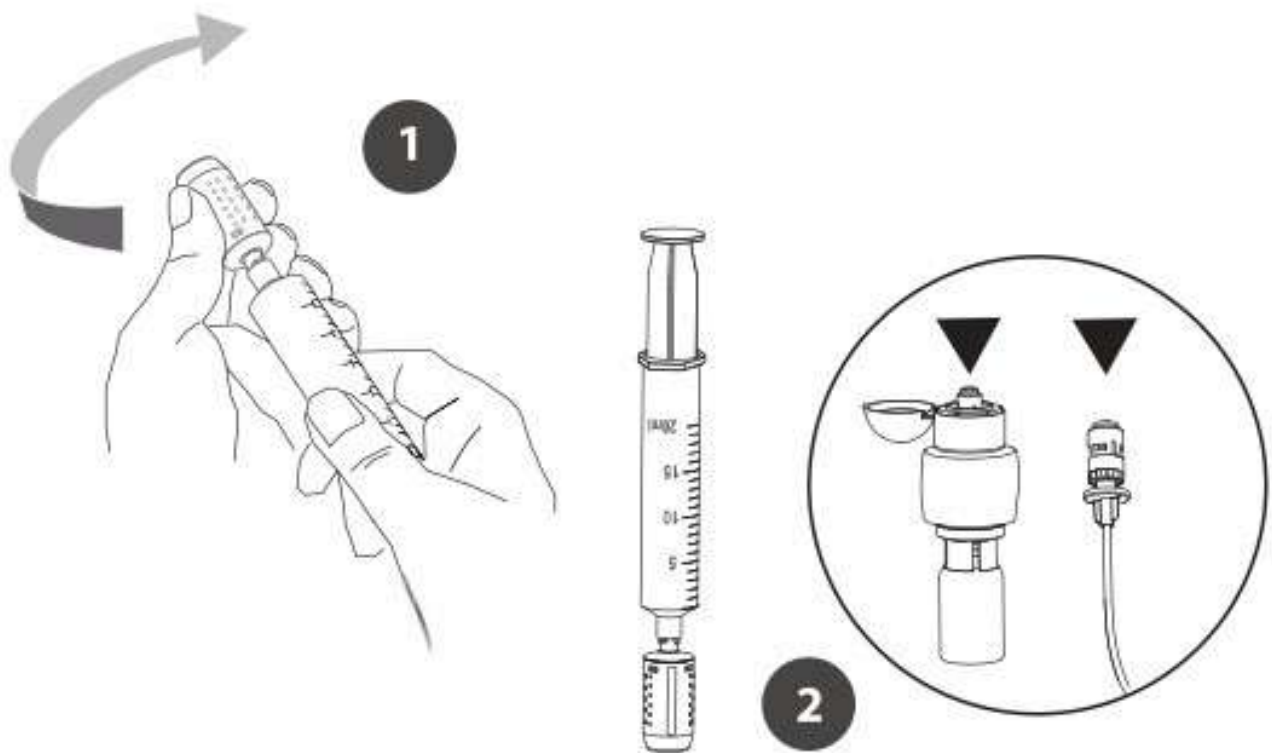

DIRECTIONS - Use Aseptic Technique

1. Connect ProSeal Injector (Syringe Adaptor) to a Luer Lock Syringe.
2. *Attach ProSeal Injector (Syringe Adaptor) with the syringe directly onto injection site of ProSeal component. Perform drug transfer.
3. Discard used syringe with ProSeal Injector (Syringe Adaptor) intact in accordance to disposal procedure for bio hazardous materials of your facility.

*Always keep ProSeal Injector aligned DIRECTLY (not at an angle) to the ProSeal Injection Site before pushing to connect.

Contraindications

The device is contraindicated whenever:

- The drug to be prepared is contraindicated to stainless steel, polypropylene, silicone and TPE.

Warnings

- Use accepted IV and pharmacy practice.
- The performance of the self-sealing membrane of the device is reduced after multiple perforations.
- Do not re-use to avoid contamination.

Precautions

- Do not use when caps and /or components are loose.
- The device is sterile unless packaging is damaged. Do not use when packaging is damaged.